

Construction of Automatic Framing and Cover

... Find out more about this Global Concept solution ...

The framing sector was previously associated to constructing roofs. The area of work for framing has now fundamentally changed. This is why the various cadwork products and modules, based on a 3D modeller, ensure that all of your projects are possible and limitless.

From traditional gable roofs to left roofs via traditional roof frames and multi-material roofs, cadwork offer support modules to help you automate your structures.

Roof Module: Get a preliminary costing in just a few clicks

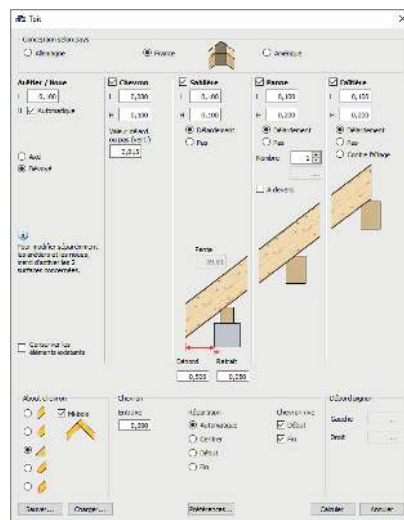

Assemble the spaces needed to shape the outer border of the roof and automatically fill in your roof with the sections of your frame. Be it purlins, rafters, lathing, hips, valleys, everything is arranged correctly and ready to be catalogued.

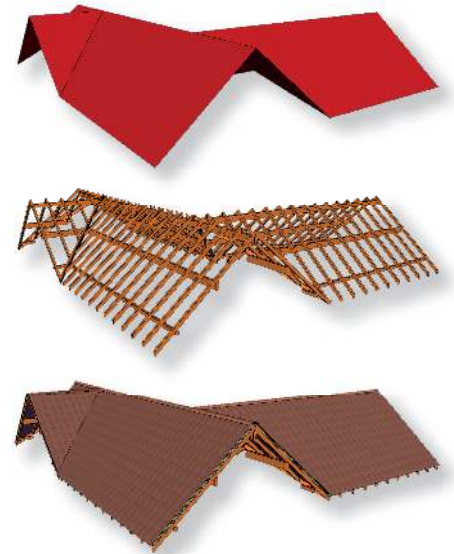

Cover module

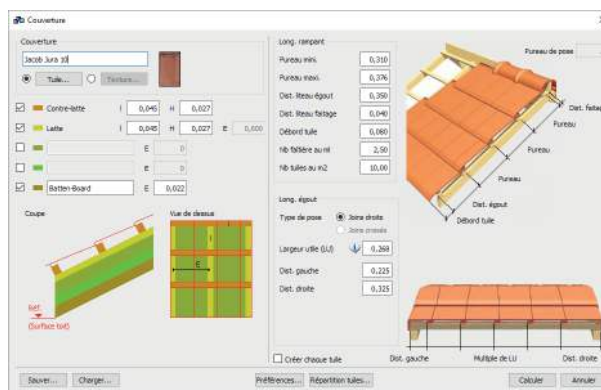

Use your acquired roofing surface areas with a theodolite, manually designed with a PDF of a site survey or simply from a design.

Activate the Cover module, choose your roof tile from the library and leave cadwork to do the rest for you.

Your tiles will automatically be laid out depending on the gauges and you will get a quantity of the utmost precision for all of the elements that make up the cover (ridge beams, tiles, etc...)

État de couverture

Systeme	Arrière	Avant	Unité
Surface toit	141,14 m ²		Nb toits de tuile
Surface auxiliaire	18,27 m ²		
	regueur d'égout	20,31 m	Nb toits de tuile
	regueur de fâlage	30,31 m	Nb toits de tuile
	regueur de lathier	30,31 m	Nb toits de lathier
	regueur de pasche	19,57 m	Nb toits de pasche
	regueur de pasche	19,57 m	Nb toits de pasche
	regueur de pasche	19,57 m	Nb toits de pasche
	regueur de pasche	19,57 m	Nb toits de pasche
	regueur de pasche	19,57 m	Nb toits de pasche

{ the pros making the difference }

- Advanced solution
- Support and tips
- Privileged follow-up
- Professionalism
- Continuing education



Parametric truss

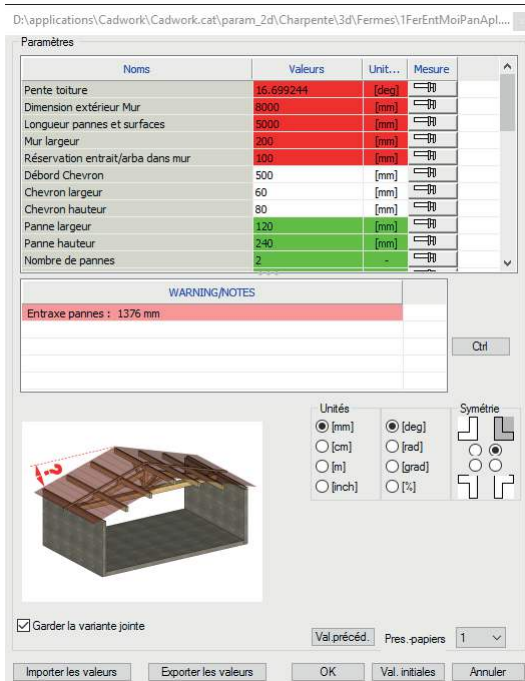

Is your building more traditional?

Use the library of parametric trusses to quickly design aesthetic structural elements, ready to be cut. On a Blochet, with strutted tie beam, traditional, most kinds of trusses are available in our catalogues for free.

Do you want to be different?

All cadwork modules provide support. If you wish, you can take over to change your elements or create new ones in cadwork 3D whenever you like.

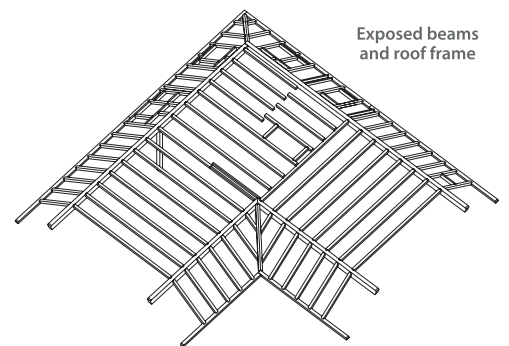
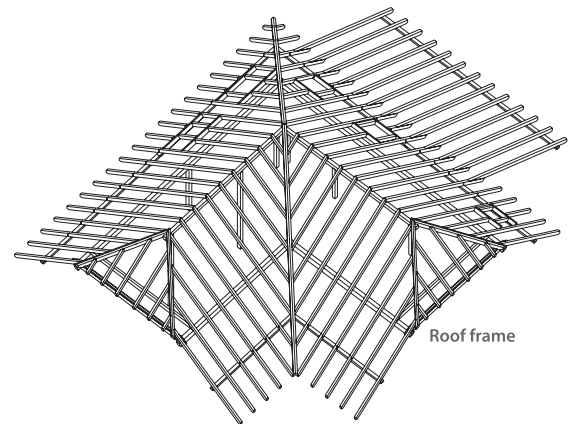

Element module

Are you going for a contemporary and refined building? Use elementation.

The roof spaces will automatically be laid out with your box beams, taking into account the roof windows, headers and ventilation. The automatic plan outputs and machine handling will help you to establish your creation as quickly as possible.

Timber truss nailed

Does your client have a more limited budget? Are you going for a timber truss nailed? Cadwork is compatible with most timber truss nailed software, Mitek, Wolf, etc.... Transfer the data that has been calculated directly into your production software. That's also what Open BIM is about.

What could possibly be better for this work than a design and manufacturing software, which encounters no limits from the get go?

The cadwork Professional Package with the automatic Roofing module is your best bet.*

Simple and intuitive software

Efficiency - Flexibility - Speed - Quality.

The flexibility, speed and quality of the preparation are today essential to any company wishing to keep up with the competition. The numerous possibilities of cadwork and its simplicity make it an indispensable tool allowing you to strengthen your position on the market.

"Try and buy option:

Following a 2-day training course, you will benefit from a 2-month free trial installation, without obligation to purchase. During this time, you have access to the modules of the full version of the software and all our services, including phone support."



The confidence of our clients, our international presence, the experience and expertise of our team guarantee a safe investment.

*Professional package: Does not include the cover and elementation functions which are sold separately.